

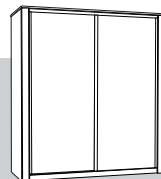

www.MLMEBLE.pl

GB D CZ SK RUS LT
assembly instructions / montageanleitung / montážní návod / montážny návod / инструкции по монтажу / surinkimo instrukcija



INSTRUKCJA MONTAŻU

OLIWIER 02N D/L

↑ 210 → 197 ↗ 166



akcesoria / accessories / zubehör / příslušenství / prislušenstvo / аксесуары / furnitūra :

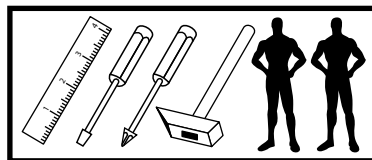

x 28 KK 8/32	x 16 KM 8/35	x 30 KT 6,3/50	x 20 ZA N	x 120 GZ 1,4/25	x 8 SG 8/8	x 8 MD	x 8 ZAM	x 2 UB 0	x 12 PA Ø5	x 6 WT 3,5x16
x 9 WTLP 3x16	x 12 BDP	x 1 drażek / stick / stock / hůl / palica / трость	x 2 LT	x 2 ZPL	x 2 ZPP	x 1 DPRD	x 1 TG	x 1 TD	x 4 WZD	x 4 WZG
x 6 WT 4x60	x 6 DT 8,2x12x35	x 4 WT 3x10	x 1 klej / glue / kleber / lepidlo / lepidlo / клей / klijaj	x 1 kluczyk / key / schlüssel / klíč / ключ / raktas	x 8 WT 4x23	x 1 ZAT	x 2 SZT L-197	x 2 SR HI-TEC		

do montażu potrzebne są:
are needed for assembly:
sind erforderlich für die montage:
jsou potřebné pro montáž:
sú potrebné pre montáž:
которые необходимы для сборки:
Surinkimui reikės:



! UWAGA! - w pierwszej kolejności wbijamy akcesoria „KK” i „MD” w blaty oraz boki.
WARNING! - The first accessory sticks "KK" and "MD" in the tops and sides.
WARNING! - Die erste Accessoire-Sticks "KK" und "MD" in den Spitzen und an den Seiten.
POZOR! - První příslušenství holi "KK" a "MD" v korunách a boky.
POZOR! - Prvé príslušenstvo palíc "KK" a "MD" v korunách a boky.
ВНИМАНИЕ! - Первый аксессуаров палочки "KK" и "MD" по верхинам и по бокам.
DĚMESIO! - Pirmiausiai furnitūrą KK ir MD įkalame į stalviršį ir šonus.

	CODE		
1	OLIWIER02N_01	660	1969
2	OLIWIER02N_02	2073	623
3	OLIWIER02N_03	2073	623
4	OLIWIER02N_04	1997	503
5	OLIWIER02N_05	1165	502
6	OLIWIER02N_06	1165	124
7	OLIWIER02N_07	1926	624
8	OLIWIER02N_08	92	1997
9	OLIWIER02N_09	1926	60
10	OLIWIER02N_10	745	502
11	OLIWIER02N_11	745	124
12	OLIWIER02N_15	745	502

	CODE		
13	OLIWIER02N_16	922	1962
14	OLIWIER02NHDF_01	382	2030
15	OLIWIER02NHDF_02	591	2030
16	OLIWIER02D02L_01	2072	70
17	4LUST-27	1462	865
18			
19			
20			
21			
22			
23			
24			

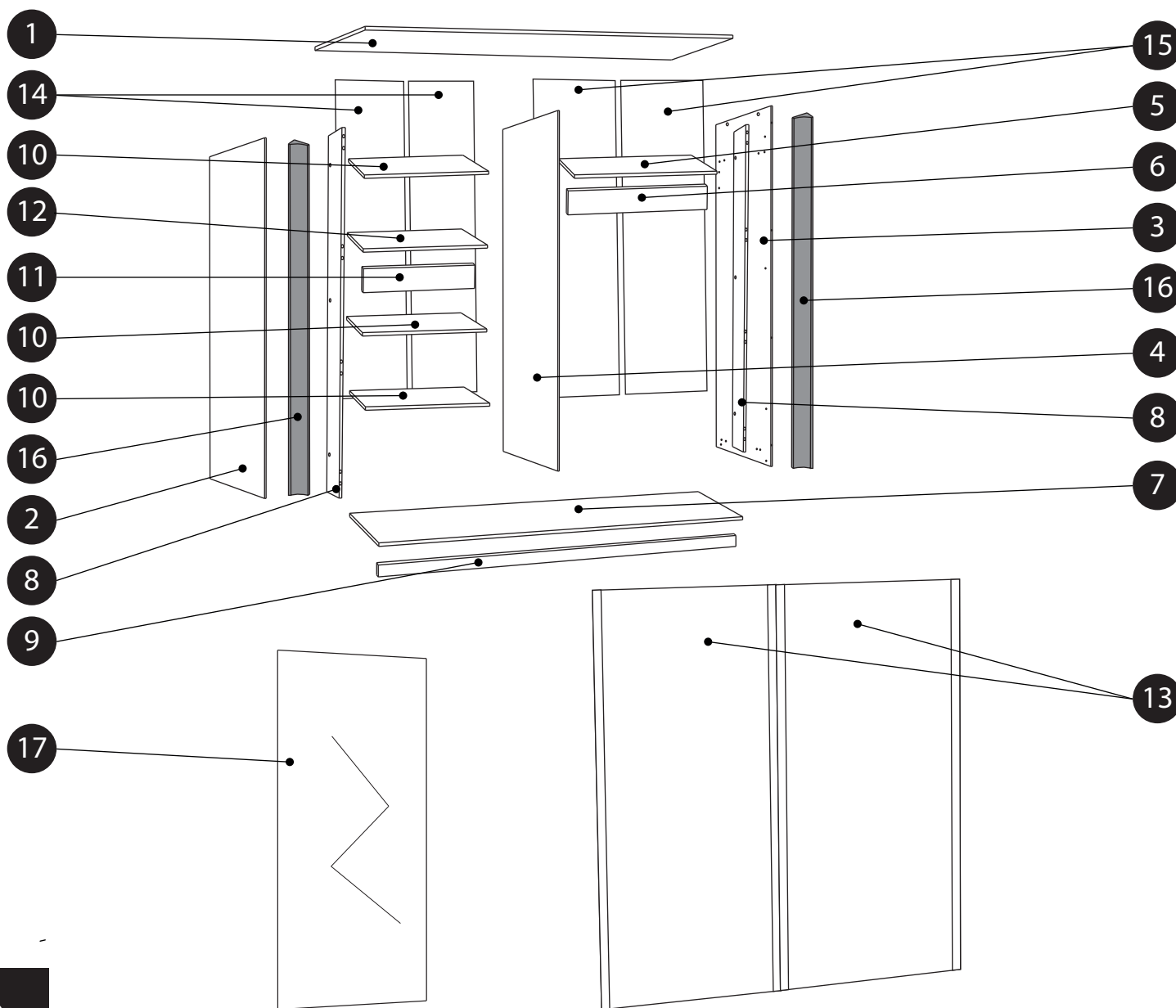
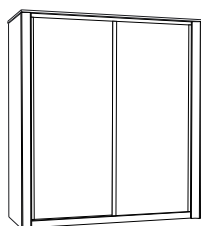

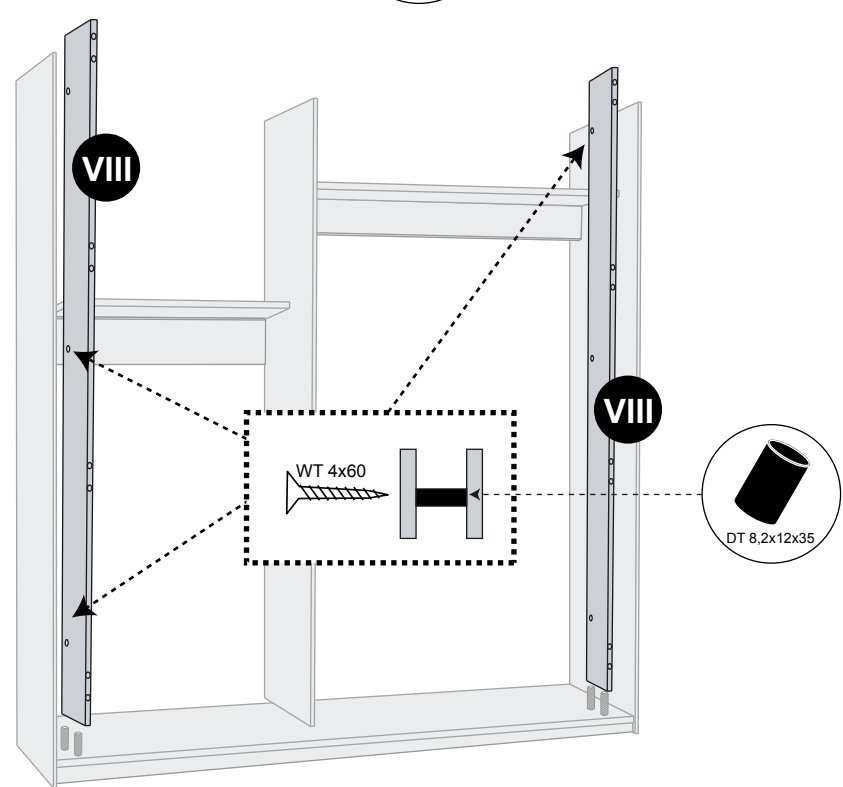
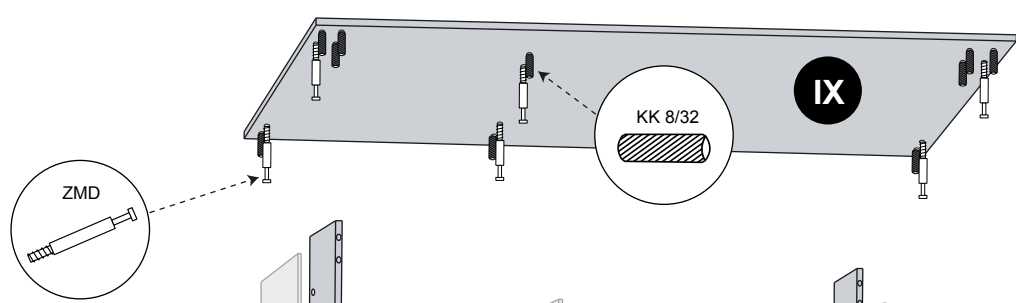
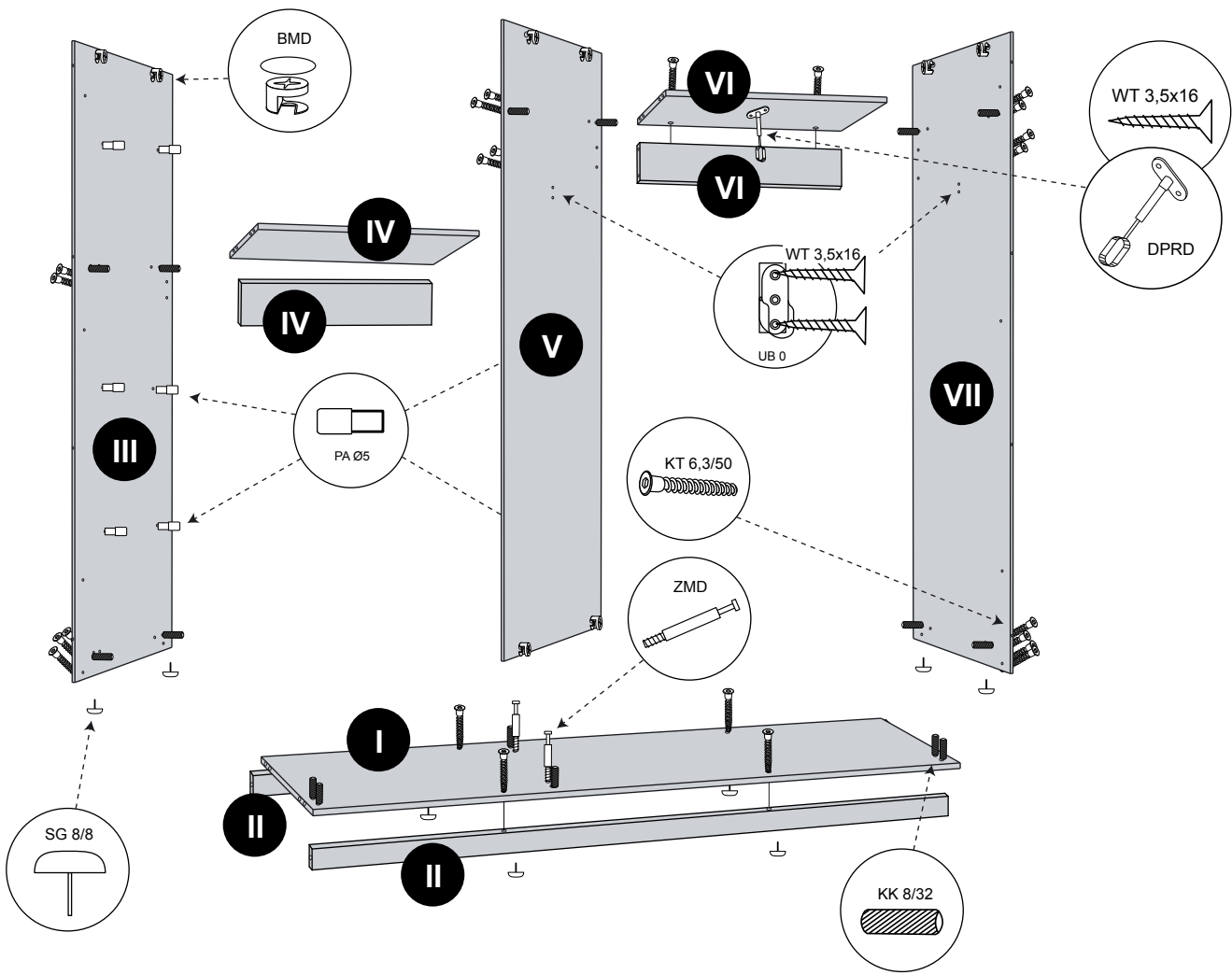

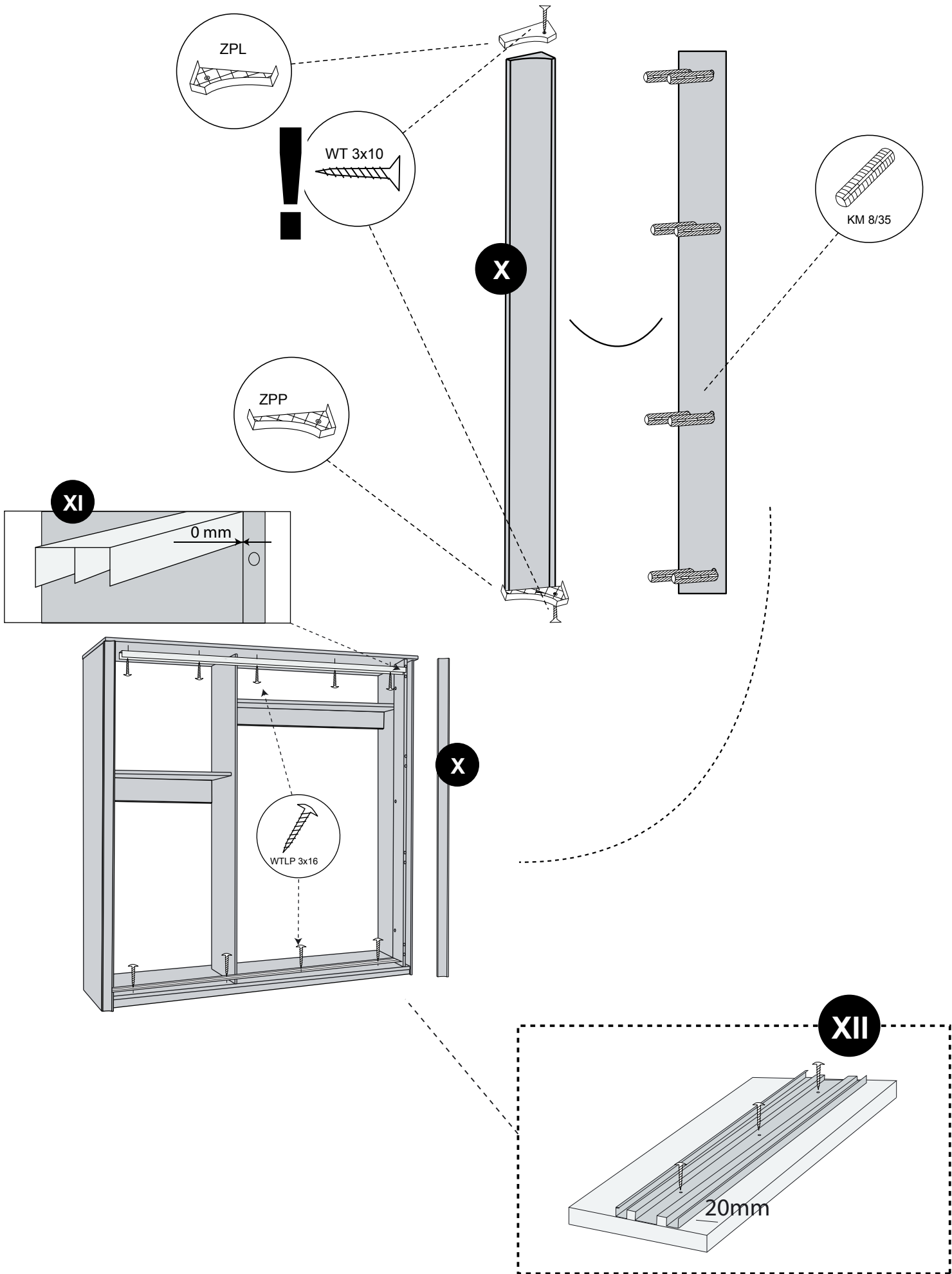

- 1** 2030x442
- 2** 2030x355

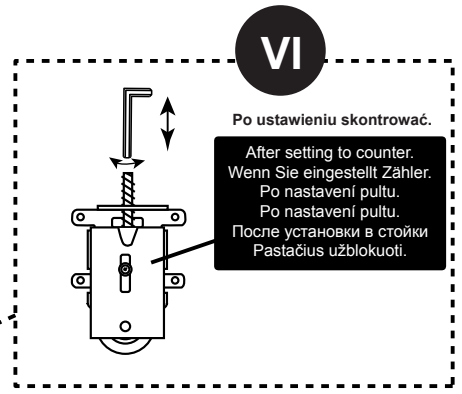
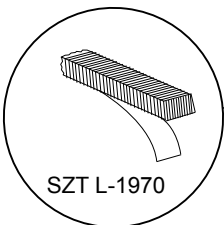
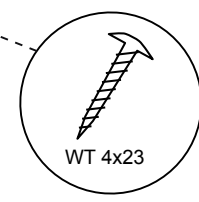
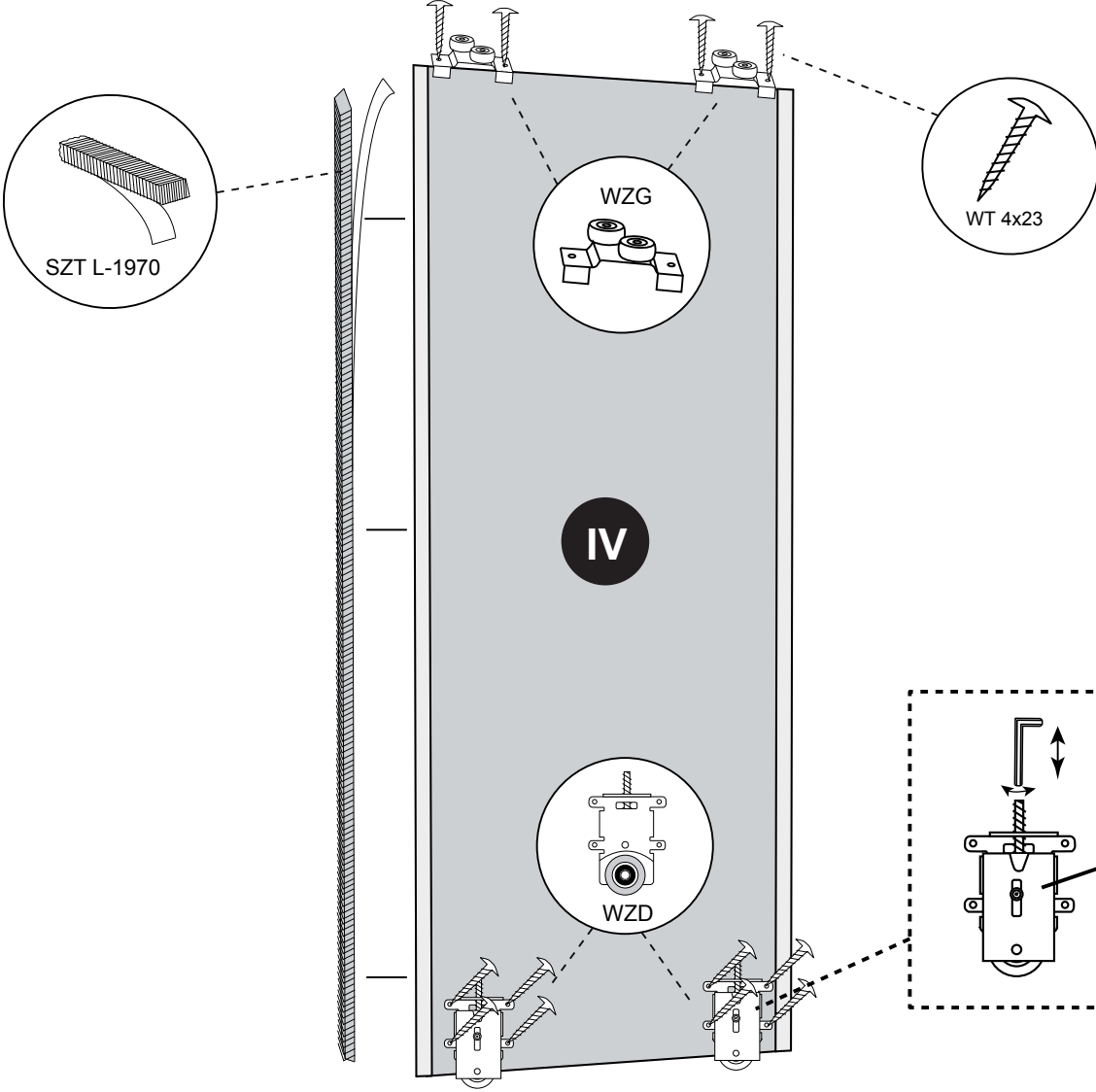
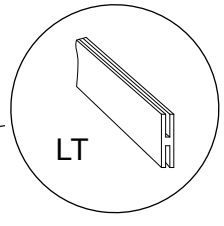
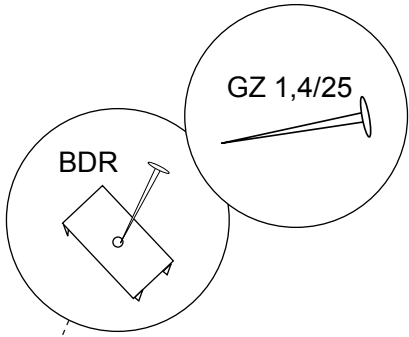
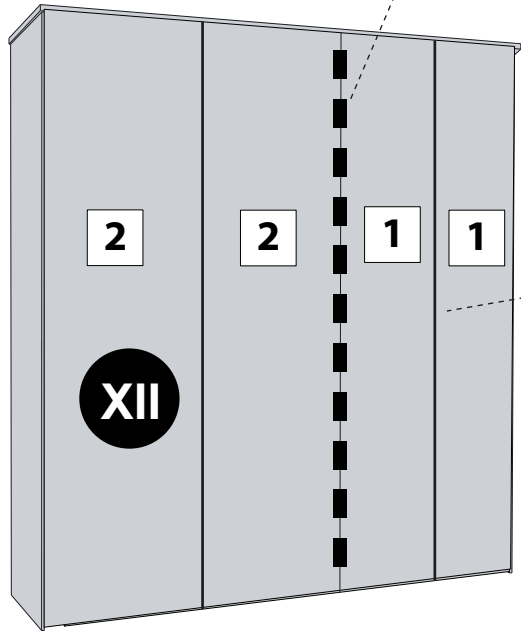

VI

Po ustawieniu skontrolować.
 After setting to counter.
 Wenn Sie eingestellt Zähler.
 Po nastavení pultu.
 Po nastavení pultu.
 После установки в стойки
 Пастаčius užblokuoti.

