

LINO

LRTV165

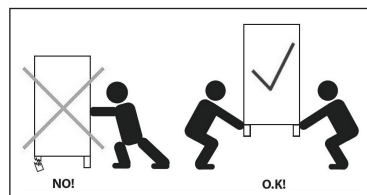
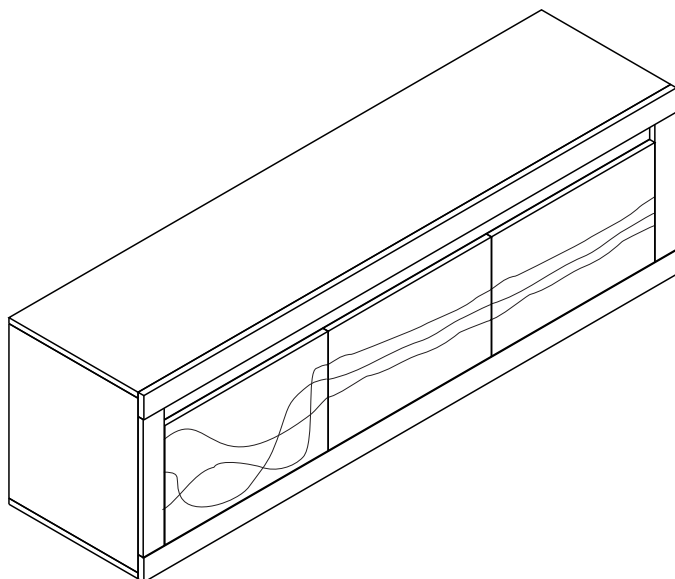

03.02.2015.

- | | |
|----------------------------------|------------------------------|
| (D) Montageanleitung | (GB) Assembly Instructions |
| (FR) Notice de montage | (IT) Istruzioni di montaggio |
| (NL) Handleiding voor de montage | (PL) Instrukcja montażu |
| (CZ) Montážní návod | (SK) Návod na montáž |
| (HU) Szerelési útmutató | (RO) Instrucțiuni de montaj |
| (TR) Montaj talimatı | (RU) ИНСТРУКЦИЯ ПО МОНТАЖУ |

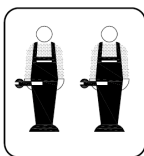
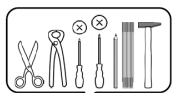

1,5 - 2

1

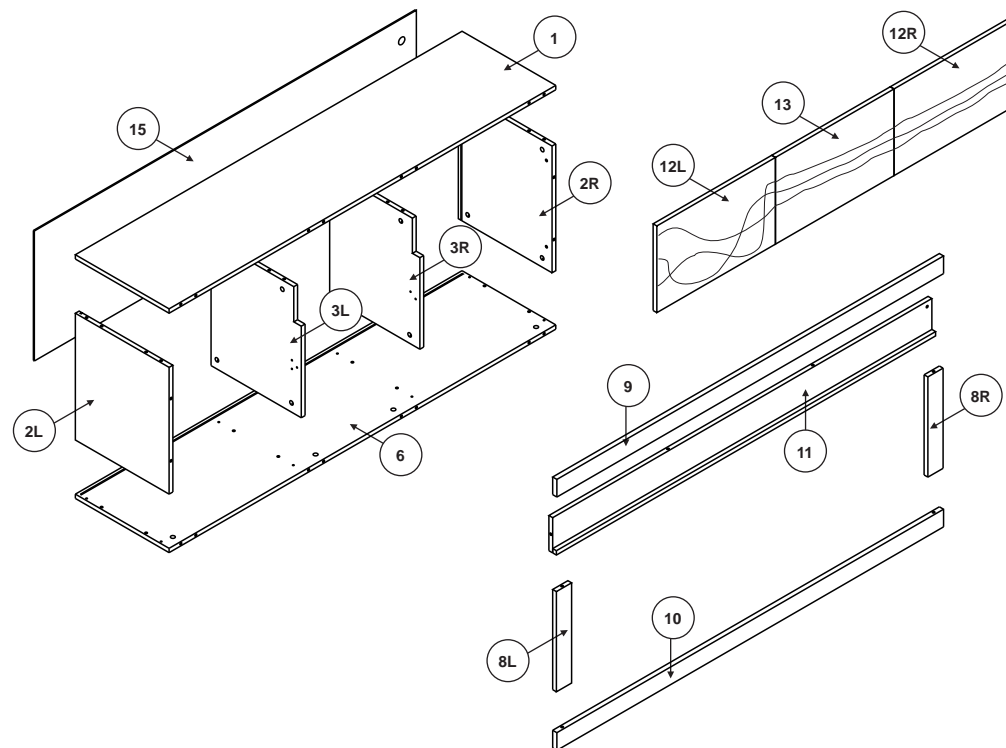

A 8x32 x36	B x24	C x24	Z x24	XB x3	NA 4x13 x12	H 6,3x13 x12
WC x8	ND 3,5x16 x15	P x6	ZF x3	X x8	R x6	N 3x20 x6

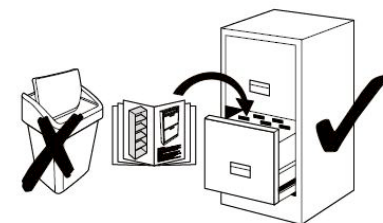
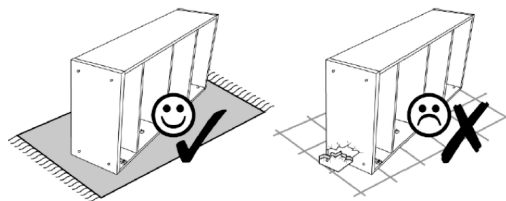
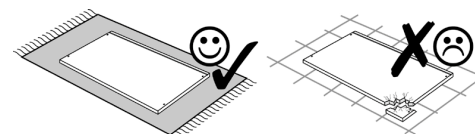

2

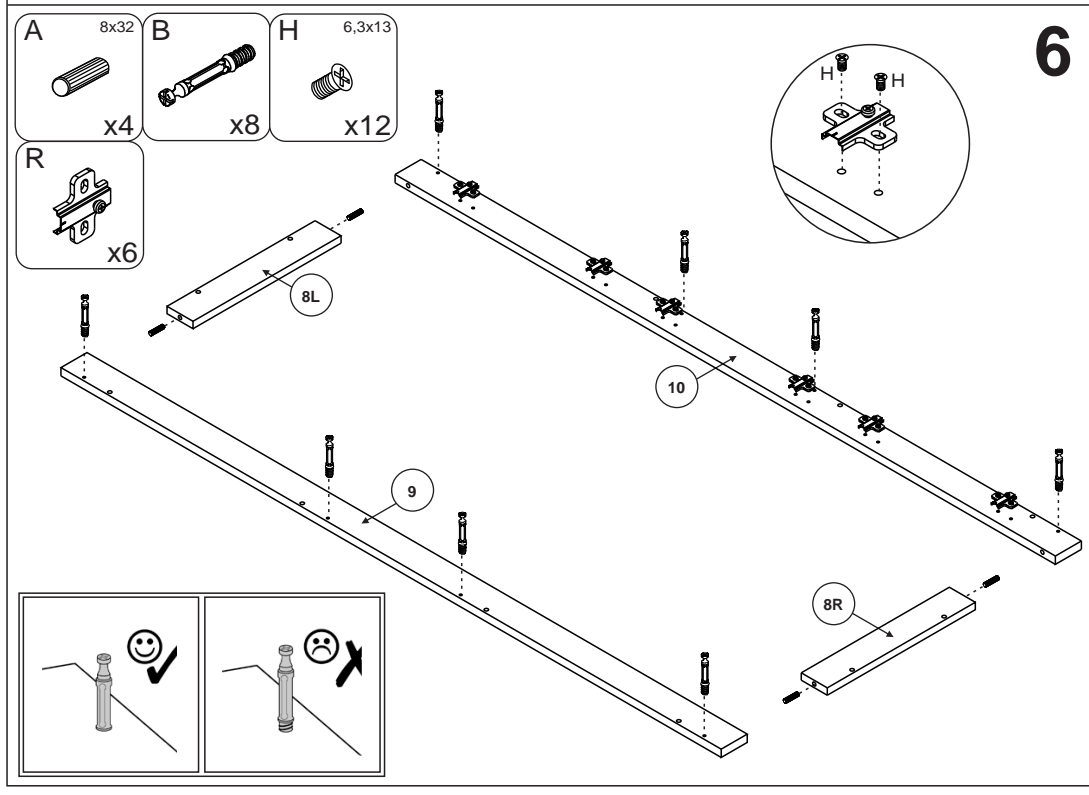
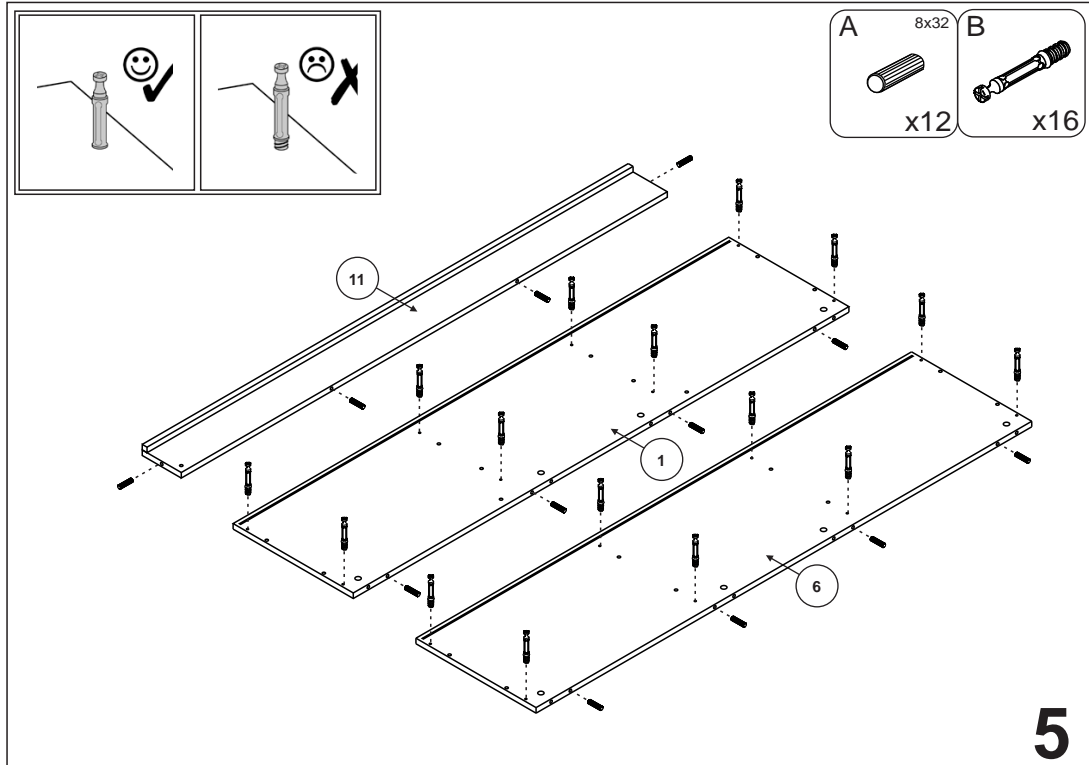
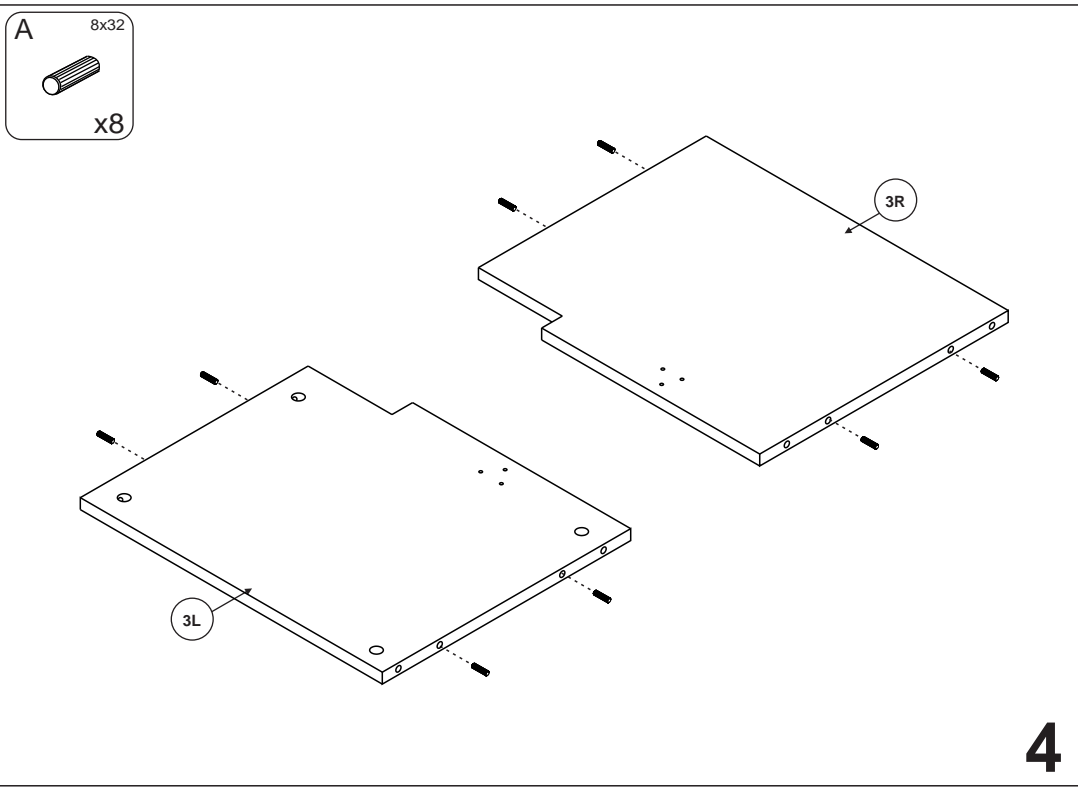
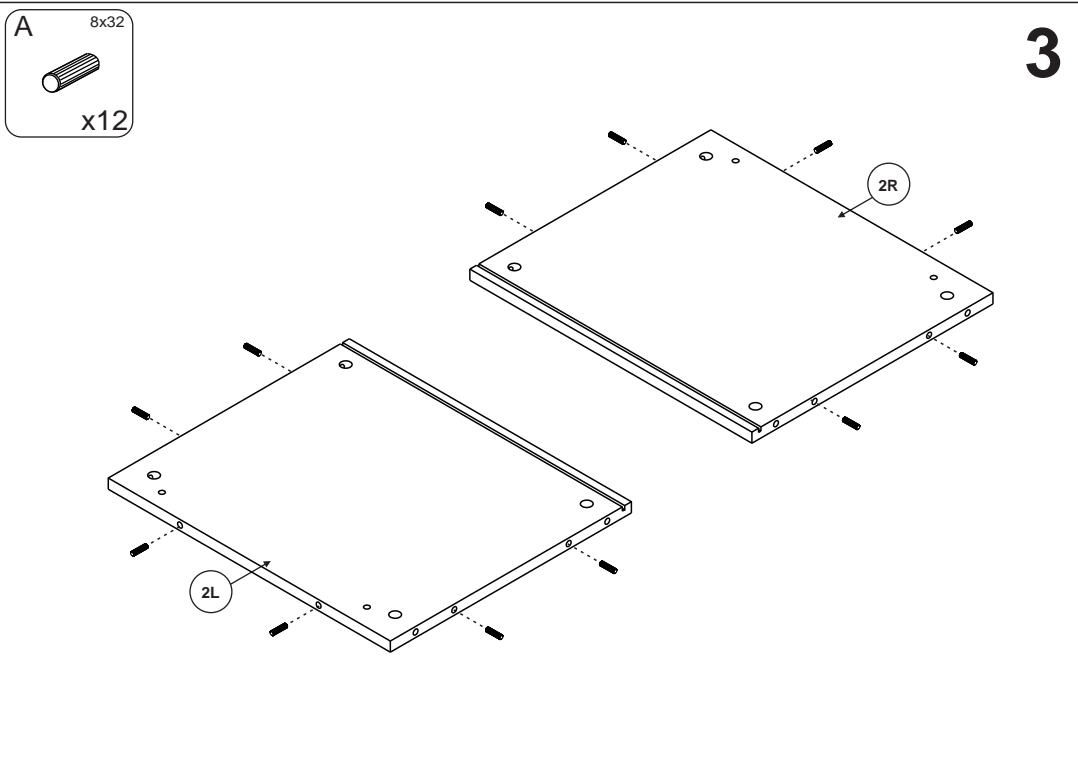

7

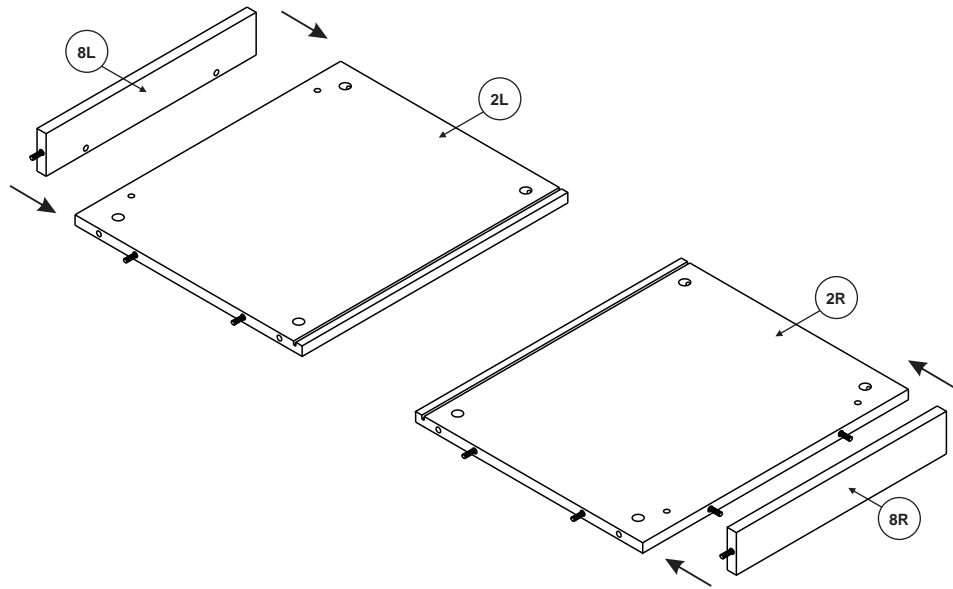

8

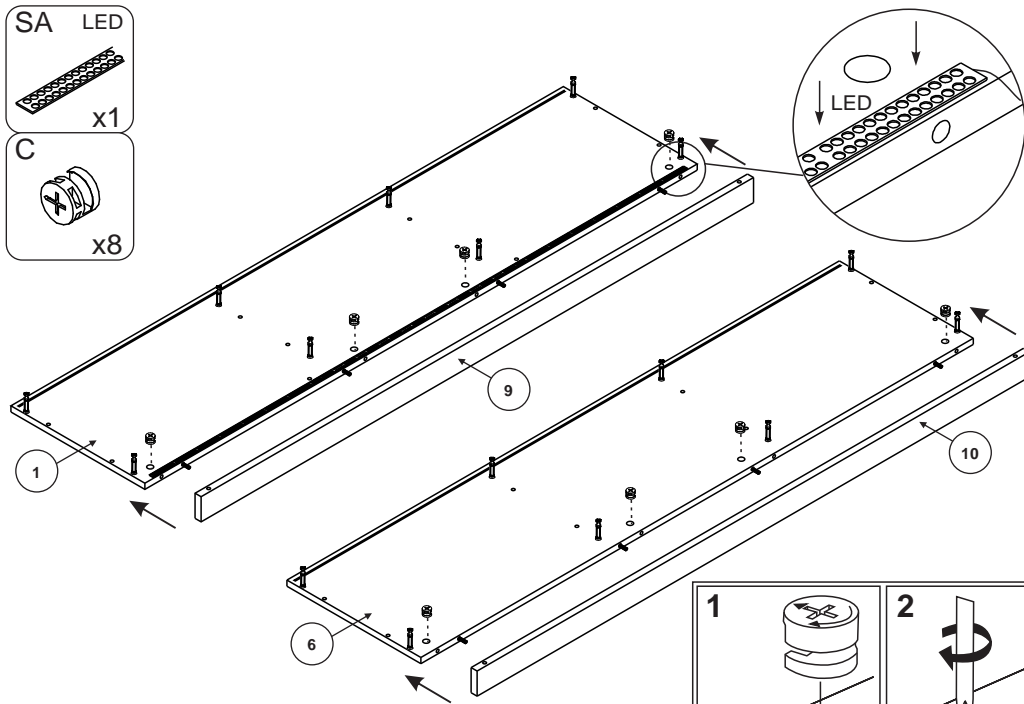

C



x8

WC



x8

x8



C



x8

9

10

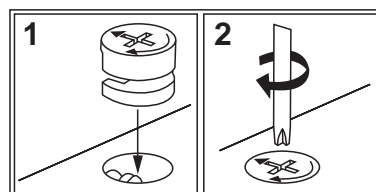
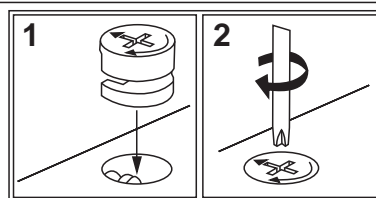
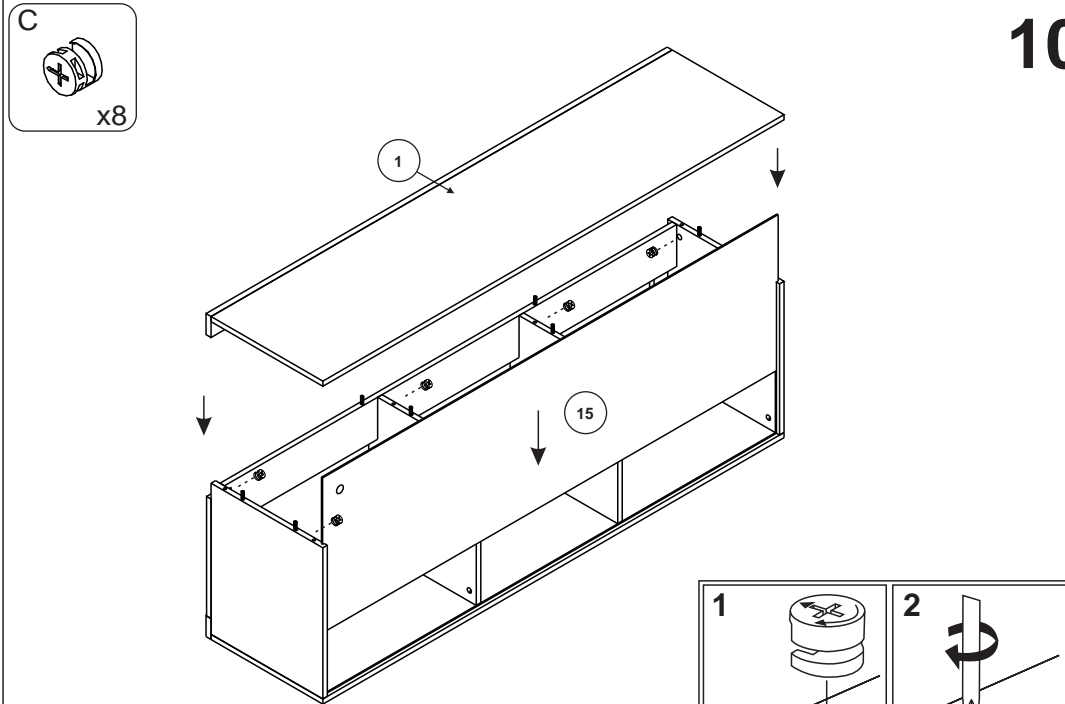

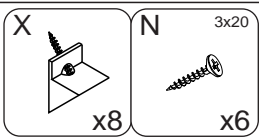

11

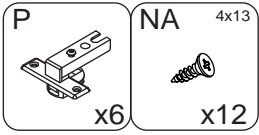
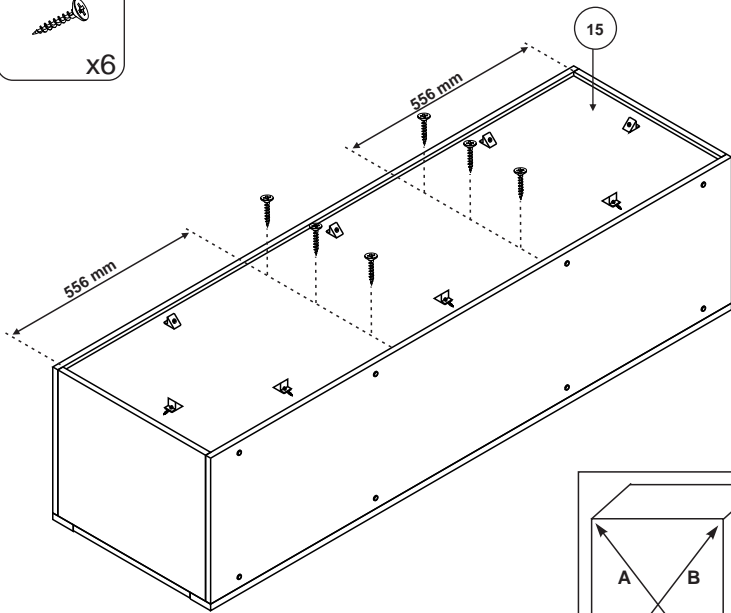

12

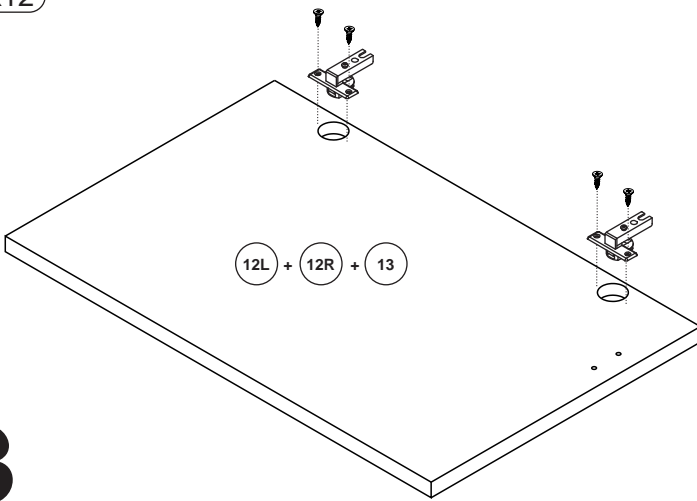

x3

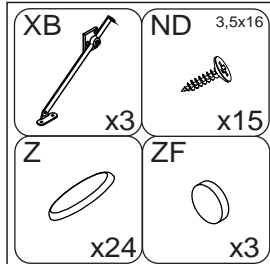

13

