

system
KOMI

KM 17

2/3

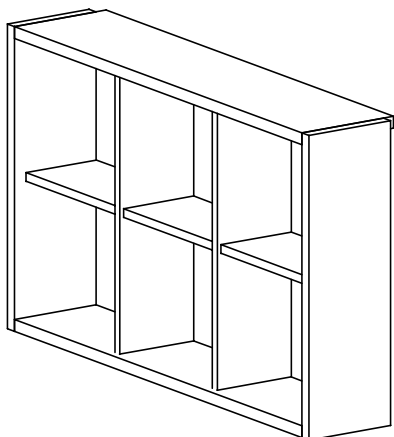

I

Lp	WYMIARY	szt
1	90,6 x 20,3	1
2	90,6 x 18	1
3	57 x 18	1
4	52,5 x 16,3	2
5	57 x 18	1
6	29,1 x 15,5	3

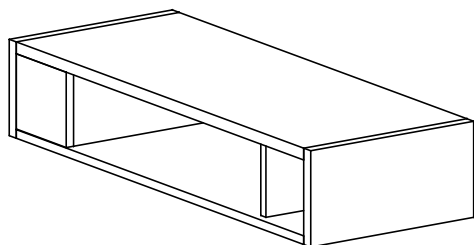

II

Lp	WYMIARY	szt
7	90,6 x 36	1
8	90,6 x 36	1
9	14,1 x 15,8	4
10	14,1 x 32,6	2
11	36 x 18	2